

OVERHEAD : HOISTWAY

TEMPORARY OVERHEAD REACTIONS (LBS.)	
R1	2,850 LBS.
R2	2,525 LBS.
R3	800 LBS.
R4	850 LBS.

TEMPORARY SUPPORT TABS AT R1-R4 ON OVERHEAD MACHINE SUPPORT STRUCTURE ARE TO BE REMOVED AFTER LIFTING ASSEMBLY WITH PROVIDED JACK BOLTS. ISOLATION IS THEN TO BE PLACED BETWEEN THE RAIL CAPS AND THE MACHINE STRUCTURE. THE MACHINE STRUCTURE WILL THEN BE LOWERED ONTO THE RAIL CAPS AND ALL ELEVATOR LOADS WILL THEN BE TRANSFERRED TO THE PIT FLOOR. (SEE PIT PLAN) HORIZONTAL BRACKETING LOADS ON RAILS WILL STILL IMPACT THE BUILDING. (SEE DATA PLAN FOR BRACKETING AND SEISMIC LOADING.)

HEAT LOAD IN CONTROLLER CLOSET CAUSED BY ELEVATOR EQUIPMENT IS IN B.T.U./HOUR UNITS PER CHART BELOW

CAR SPEED	WITHOUT TRANSFORMER	WITH TRANSFORMER	REGENERATIVE DRIVE
8 MM ROPE	200	1,025	1,505
10 MM ROPE	200	1,290	1,845
350	2,070	3,045	NO

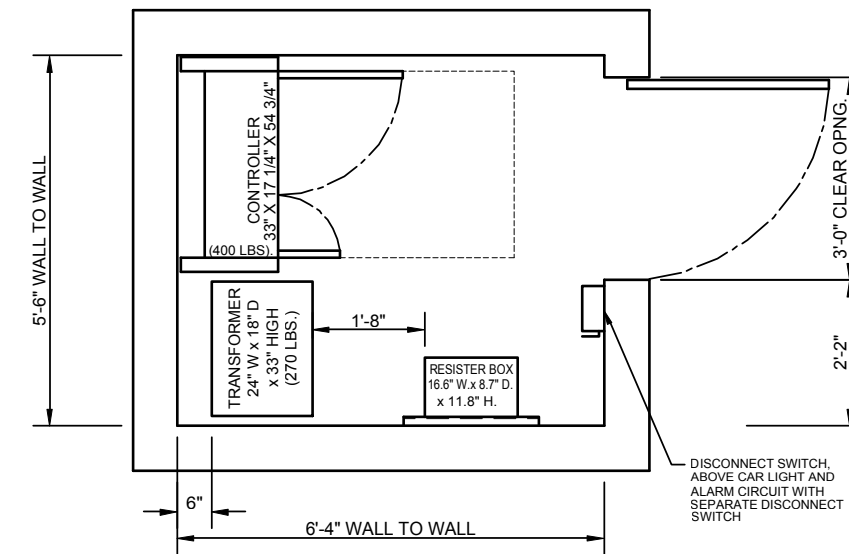

CONTROLLER CLOSET

DISCONNECT SWITCH (BY OTHERS)  
 TEMPERATURE RANGE (32° F MIN., 104° F MAX.)  
 10% - 95% NON-CONDENSING RELATIVE HUMIDITY  
 7'-6" MIN. CEILING HEIGHT

\* PREFERABLY THE CONTROL CLOSET SHOULD BE LOCATED AT THE TOP LANDING AND THE MAX DIST. OF CONDUIT RUN FROM CONTROLLER TO MACHINE IS 150'.

(2) 6" WIDE X 6" HIGH ELECTRICAL RACEWAYS REQUIRED. LOCATION IS DETERMINED BY RELATIONSHIP BETWEEN CONTROLLER CLOSET AND HOISTWAY. FINAL LOCATION TO BE VERIFIED WITH THYSSENKRUPP FIELD SUPERINTENDENT.

DATE	SYM.	REVISION	BY	CHKD.

FOR:

THIS DRAWING AND ALL INFORMATION THEREON IS THE PROPRIETARY PROPERTY OF THYSSENKRUPP ELEVATOR AND MUST NOT BE MADE PUBLIC OR COPIED. THIS DRAWING IS LOANED SUBJECT TO RETURN ON DEMAND AND IS NOT TO BE USED, DIRECTLY OR INDIRECTLY, IN ANY WAY DETRIMENTAL TO THE INTEREST OF THYSSENKRUPP ELEVATOR.

DO NOT SCALE THIS DRAWING

SYNERGY SEISMIC 100R 3520/3535

**ThyssenKrupp Elevator Americas**



DALLAS, TX

DRAWN	DATE	CHKD.	JOB NUMBER	REV.	SHEET NO.
X	XX/XX 20XX		X		3 OF 3